

How to Guide

Install Rotors



This brochure includes useful information and basic guidelines that allow you to understand and install rotors. For more specific and detailed information about rotors or if you have further questions contact a professional or call 1-800-RAIN BIRD.



Rotors are for quiet, low maintenance watering of medium to large lawn areas. Where grit, sand or heavy duty grasses are a problem you can utilize an efficient impact drive mechanism or a closed case sprinkler.

System Overview

An irrigation system consists of a timer, valves and sprinklers.

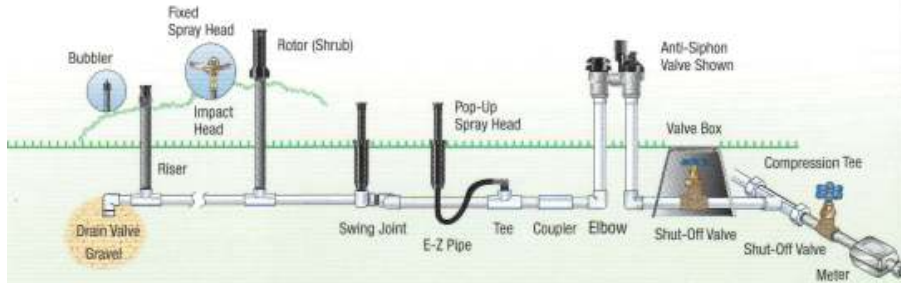

Valves are controlled by the controller, each valve controls the amount of water going out to each station of sprinklers. When the programmed watering time has been completed, the valve shuts off and the next station will continue watering. So each station waters one at a time at its own programmed schedule and duration.

The number of sprinklers that can be connected to one valve is determined by the gallons per minute (GPM) available in your system and the type of sprinkler and nozzle to be used. Some sprinklers require more gallonage than others to achieve optimum watering.

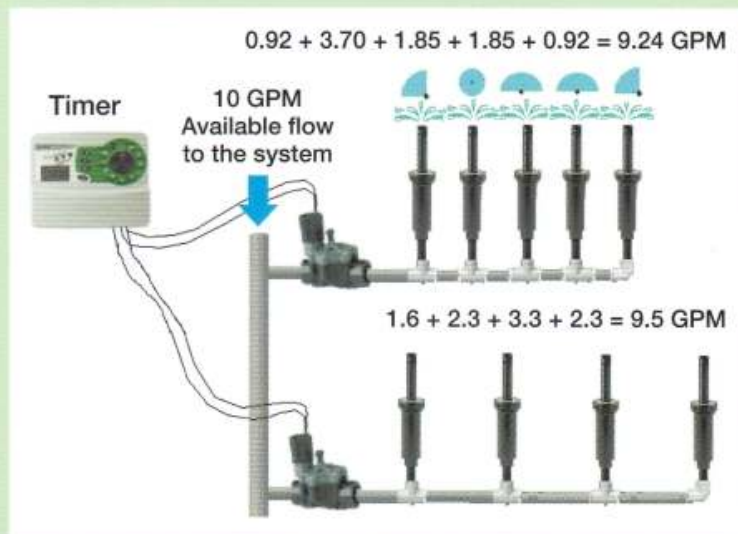

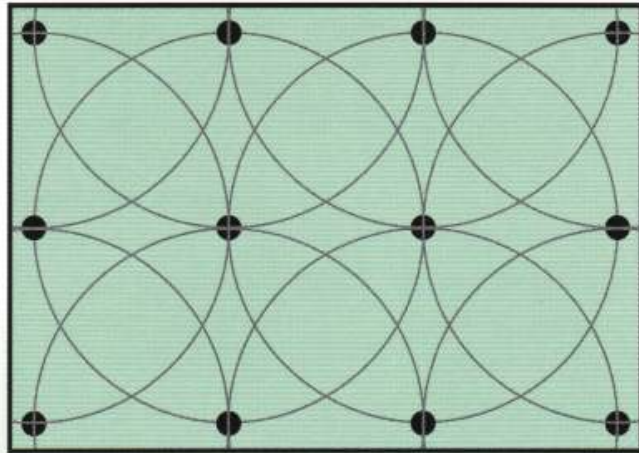

Head to Head Coverage

Before you install your sprinklers, make sure you have an accurate layout with sprinkler locations to achieve optimal watering performance. Rain Bird can design your irrigation system for you.

Call 1-800-426-7782 to find out how fast and easy it is.

Most rotors adjust from full to part circle, giving you complete control to put water where you need it, and ensuring head-to-head coverage.

To ensure proper watering and reduce the chance of brown spots in your lawn, adjust your rotor spray pattern to get head-to-head coverage.



How to Install

POP-UP IMPACT SPRINKLERS

Pop-up impact sprinklers provide the convenience and reliability homeowners want and retract out of sight when not in use. These heavy duty impacts have the strength and performance of industrial and commercial products, yet are easy to install and operate. Pop-up impact sprinklers are long lasting, and particularly noted for their performance with heavy-mineral content, such as hard water and well water, that can clog and corrode other sprinklers. Also an excellent choice for reclaimed water irrigation systems in drought areas.

INSTALLATION TIPS

1. Flush the piping system thoroughly before installing the sprinklers.
2. Use only Teflon tape on the connecting pipes or fittings. Do not use PVC cement or other glues as they may chemically damage the threads. Install the sprinklers so that the flanged area is positioned level with the ground.

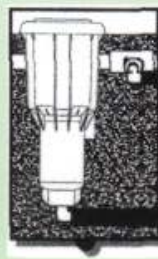

HOW TO ACCESS THE INTERNAL ASSEMBLY

To change the nozzle on your sprinkler, you will have to lift the cover to be able to access the internal assembly. There are two ways to do this: you may find it easiest to use a wrench to lift and hold up the internal assembly; however, it is also possible to use your hands.

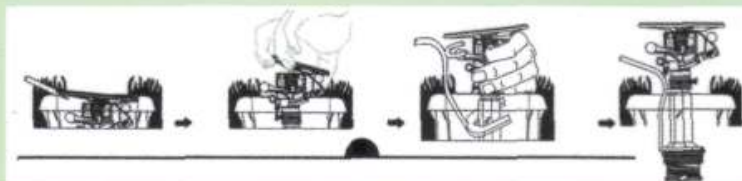

HOW TO SET THE WATERING PATTERN

1. After installation (easier to adjust with the water on) locate the two pattern adjusters, or trip collars, and the trip lever. To water full circle: flip the trip lever up, allowing the head to rotate in a complete circle.
2. To water a part circle: flip the trip lever down, then slowly move the two pattern adjusters. The sprinkler will water the angle you set with the pattern adjusters (on the opposite side of the trip lever).



CLOSED CASE ROTOR SPRINKLERS

Closed-case rotor sprinklers are for long life, quiet operation and maximum design flexibility. The protected closed-case design makes these sprinklers ideal for "creeping" grasses, sandy soil and other harsh surroundings.

HOW TO FIND YOUR FIXED LEFT EDGE

Using the palm of your hand, turn the center cap to the right until it stops. Then turn it to the left until it stops. This is your fixed left edge, which is the starting point from which rotation begins. Arc is preset to rotate 180° (Half-circle).



HOW TO ADJUST THE PATTERN

Using a flat bladed screwdriver, turn the arc adjustment screw clockwise (+) to increase the arc or counter-clockwise (-) to decrease the arc. Pattern is adjustable from 40 to 360 degrees. If adjusting the screw while the rotor is operating, always adjust in the direction of rotation.

HOW TO ADJUST THE SPRAY DISTANCE

Using a flat bladed screwdriver, turn the radius reduction screw to reduce the spray distance up to 25%.



Troubleshooting Guide

Problem	Solution
1. Water is not reaching the specified distance.	- Use larger nozzle or reduce number of sprinklers per zone.
2. Water spray seems to come out in an irregular pattern.	- Change the filter. - Flush the system. - Clean each nozzle.
3. Rotor is not popping up all the way.	- Use fewer heads. - Clean the filter. - Change to smaller nozzle.
4. Sprinklers are not rotating.	- Verify the water pressure. - Clean the filter. - Check pattern settings.



**Golden Rule
Property Inspections, LLC**

Jerry Yost

www.MyTexasInspector.com

MyTexasInspector@hotmail.com

940-367-7730

Certified Professional Inspector by NACHI



TREC Licensed Professional Inspector #09097

**Rain Bird Corporation
Consumer Products Division**

© 2008 Rain Bird Corporation
® Trademark of Rain Bird Corporation

D33704G Rev02/08